



UVブロックタイプ
(UV BLOCK TYPE)
UVB

■ 交流 メタルハライドランプ (AC Metal Halide Lamp)

シングルエンド (Single-ended)

形式 Lamp Type	定格電圧 Voltage (V)	定格電力 Wattage (W)	全光束 Total Flux (lm)	色温度 Color temperature (K)	平均寿命 Average Life (h)	点灯の向き Burning position	口金形式	Efficacy Source (lm/W)	CRI (Ra)	Lamp Current (A)	UVB	Fig. No.
KHD 400 HR	70	400	33000	6000	750	Any	GZZ9.5	83	≧ 90	6.9	○	1
KHD 575 HR	95	575	49000	6000	1000	Any	G22	85	≧ 90	7	○	2
KHD 800 HR	95	800	65000	6000	1000	Any	G22	81	≧ 95	8.4	○	3
KHD 1200 HR	100	1200	110000	6000	1000	Any	G38	92	≧ 95	13.8	○	4
KHD 1600 HR	150	1600	150000	6000	750	Any	G22	94	≧ 95	10.7	○	5
KHD 1800 HR	150	1800	165000	6000	750	Any	G38	92	≧ 95	14.6	○	6
KHD 2500 HR	115	2500	240000	6000	500	Any	G38	96	≧ 95	25.6	○	7
KHD 4000 HR	200	4000	380000	6000	500	Any	G38	95	≧ 95	24	○	8
KHD 6000 HR	125	6000	570000	6000	300	Any	GY38	95	≧ 95	55		9
KHD 9000 HR	170	9000	875000	6000	400	Any	GX38	97	≧ 95	56		10
KHD 12000 HR	160	12000	1200000	6000	300	Any	GY38	100	≧ 95	84		11
KHD 12000 HR/H	160	12000	1200000	7000	300	Any	GY38	100	≧ 95	84		11
KHD 18000 HR	225	18000	1650000	6000	300	Any	GY51	92	≧ 95	88		12

Fig.1

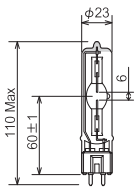

Fig.2

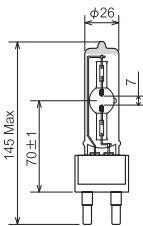

Fig.3

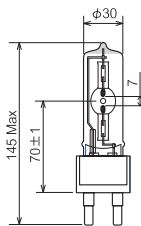

Fig.4

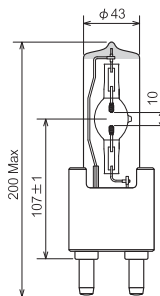

Fig.5

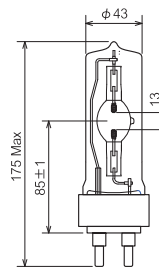

Fig.6

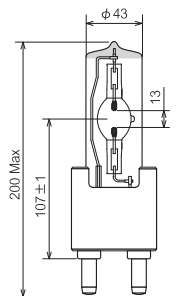

Fig.7

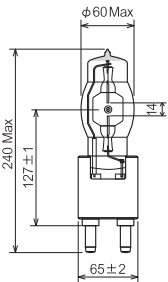

Fig.8

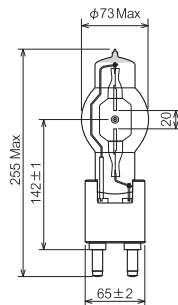

Fig.9

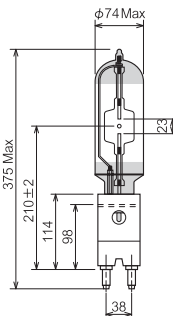

Fig.10

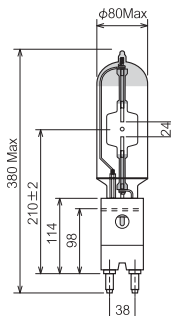

Fig.11

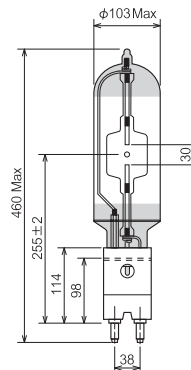
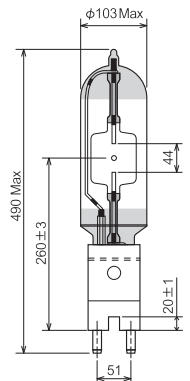

Fig.12





交流 メタルハライドランプ (AC Metal Halide Lamp)

ダブルエンド(Double-ended)

形式 Lamp Type	定格電圧 Voltage (V)	定格電力 Wattage (W)	全光束 Total Flux (lm)	色温度 Color temperature (K)	定格寿命 Life (h)	点灯の向き Burning position	口金形式	A Max (mm)	B (mm)	C (mm)	D (mm)	Fig. No.
KHD 575/DE	95	575	49000	6000	750	ANY	SFc10-4	138	115±1	7±0.5	φ 19±0.5	1
KHD 575/DE/2	95	575	47000	6800	750	ANY	SFc10-4	138	115±1	7±0.5	φ 19±0.5	1
KHD 1200/DE	100	1200	90000	6000	750	ANY	SFc15.5-6	220	180±1	10±0.5	φ 26±0.5	2
KHD 1800/DE	100	1800	155000	6000	750	ANY	SFc15.5-6	220	180±1	10±0.5	φ 26±0.5	2
KHD 1200/S/DE-6K	100	1200	110000	6000	750	ANY	SFc10-4	138	115±1	7±0.5	φ 21±0.5	1
KHD 18000/HR/DE	240	18000	1650000	6000	300	ANY	S30	500	—	44	φ 71	3

Fig.1

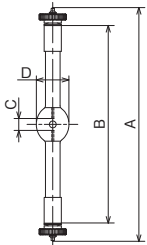

Fig.2

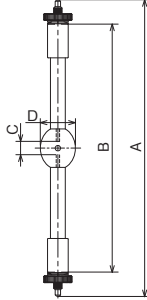
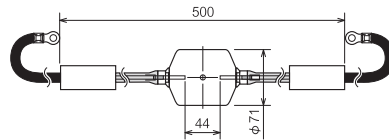

Fig.3



直流 リフレクターメタルハライドランプ (DC Metal Halide Lamp with Reflector)

形式 Lamp Type	定格電圧 Voltage (V)	定格電力 Wattage (W)	照度 Luminous Flux (lx)	色温度 Color temperature (K)	定格寿命 Life (h)	点灯の向き Burning position	口金形式	Arc gap (mm)	A (mm)	B Max (mm)	C (mm)	D Max (mm)	Fig. No.
KHD/R 250 /DC	60	250	7000	6000	2000	HORIZ	SFc10-4	2.4	110	28	56	20	3
KHD/R 350 /DC	60	350	8000	6000	2000	HORIZ	SFc10-4	2.5	110	28	56	20	3
KHD/R 375 /DC	60	375	注1	5000	2000	HORIZ	SFc10-4	2.5	110	28	56	20	3

注1) 5700Lm: φ11.3mm, L=1000mmファイバーを使用した先端出射部の平均初期値

Fig.3

